

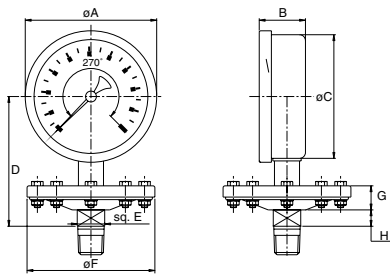

# Sizes and weights series 1520

### 1520 bottom male



Size	A	B	C	D	E	F		G	H
						5-200 ”H <sub>2</sub> O	10-600 psi		
4	4.13	1.46	3.90	4.25	0.87	5.60	4.00	0.79	0.51
6	6.22	1.50	5.85	5.24	0.87	5.60	4.00	0.79	0.51
100	105	37	99	108	22	142	102	20	13
150	158	38	148.5	133	22	142	102	20	13

### 1520 bottom female

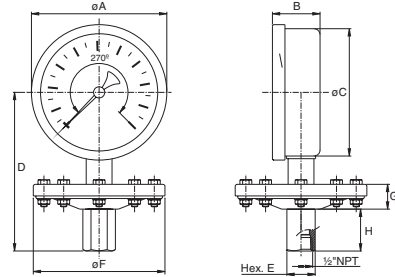

Size	A	B	C	D	E	F		G	H
						5-200 ”H <sub>2</sub> O	10-600 psi		
4	4.13	1.46	3.90	5.31	1.06	5.60	4.00	0.79	1.57
6	6.22	1.50	5.85	6.30	1.06	5.60	4.00	0.79	1.57
100	105	37	99	135	27	142	102	20	40
150	158	38	148.5	160	27	142	102	20	41



### 1521 with flange connection 5-200”H<sub>2</sub>O

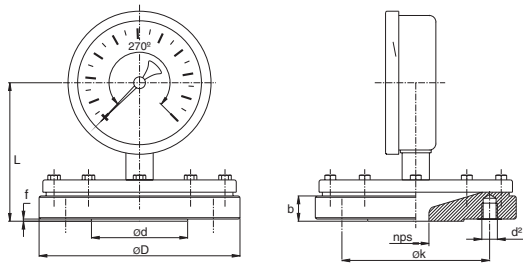

Nom. pipe size	Class	D	k	d	b	f	d <sup>2</sup> (UNC)	L gauge	L gauge
								Ø 100	Ø 150
1/2"	150	5.43	2.38	1.38	1.12	0.06	4 x 1/2"	4.47	5.45
	300	5.43	2.62	1.38	1.10	0.06	4 x 1/2"	4.45	5.43
3/4"	150	5.43	2.75	1.69	1.08	0.06	4 x 1/2"	4.43	5.41
	300	5.43	3.25	1.69	1.26	0.06	4 x 5/8"	4.61	5.59
1"	150	5.43	3.12	2.00	1.04	0.06	4 x 1/2"	4.39	5.37
	300	5.43	3.50	2.00	1.26	0.06	4 x 5/8"	4.61	5.59
1 1/2"	150	5.00	5.43	2.88	0.96	0.06	4 x 1/2"	4.31	5.30
	300	6.12	4.50	2.88	1.28	0.06	4 x 3/4"	4.63	5.61
2"	150	6.00	4.75	3.62	1.06	0.06	4 x 5/8"	4.41	5.39
	300	6.50	5.00	3.62	1.06	0.06	4 x 5/8"	4.41	5.39
1/2"	150	138.0	60.5	34.9	28.5	1.60	4 x 1/2"	113.5	138.5
	300	138.0	66.7	34.9	28.0	1.60	4 x 1/2"	113.0	138.0
3/4"	150	138.0	69.8	42.9	27.5	1.60	4 x 1/2"	112.5	137.5
	300	138.0	82.5	42.9	32.0	1.60	4 x 5/8"	117.0	142.0
1"	150	138.0	79.3	50.8	26.5	1.60	4 x 1/2"	111.5	136.5
	300	138.0	88.9	50.8	32.0	1.60	4 x 5/8"	117.0	142.0
1 1/2"	150	138.0	98.5	73.0	24.5	1.60	4 x 1/2"	109.5	134.5
	300	155.5	114.3	73.0	32.5	1.60	4 x 3/4"	117.5	142.5
2"	150	152.4	120.6	92.0	27.0	1.60	4 x 5/8"	112.0	137.0
	300	165.1	127.0	92.0	27.0	1.60	4 x 5/8"	112.0	137.0

### 1521 with flange connection 10-600 psi

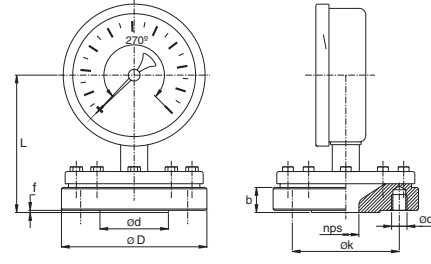

Nom. pipe size	Class	D	k	d	b	f	d <sup>2</sup> (UNC)	L gauge	L gauge
								Ø 100	Ø 150
1/2"	150	3.86	2.38	1.38	0.98	0.06	4 x 1/2"	4.33	5.31
	300	3.86	2.62	1.38	0.94	0.06	4 x 1/2"	4.29	5.28
3/4"	150	3.86	2.75	1.69	0.94	0.06	4 x 1/2"	4.29	5.28
	300	4.62	3.25	1.69	1.02	0.06	4 x 5/8"	4.37	5.35
1"	150	4.25	3.12	2.00	0.85	0.06	4 x 1/2"	4.19	5.18
	300	4.88	3.50	2.00	1.00	0.06	4 x 5/8"	4.35	5.33
1 1/2"	150	5.00	3.88	2.88	0.91	0.06	4 x 1/2"	4.25	5.24
	300	6.12	4.50	2.88	1.28	0.06	4 x 3/4"	4.63	5.61
2"	150	6.00	4.75	3.62	0.75	0.06	4 x 5/8"	4.09	5.08
	300	6.50	5.00	3.62	0.87	0.06	4 x 5/8"	4.21	5.20
1/2"	150	98.0	60.5	34.9	25.0	1.60	4 x 1/2"	110.0	135.0
	300	98.0	66.7	34.9	24.0	1.60	4 x 1/2"	109.0	134.0
3/4"	150	98.0	69.8	42.9	24.0	1.60	4 x 1/2"	109.0	134.0
	300	117.5	82.5	42.9	26.0	1.60	4 x 5/8"	111.0	136.0
1"	150	108.0	79.3	50.8	21.5	1.60	4 x 1/2"	106.5	131.5
	300	124.0	88.9	50.8	25.5	1.60	4 x 5/8"	110.5	135.5
1 1/2"	150	127.0	98.5	73.0	23.0	1.60	4 x 1/2"	108.0	133.0
	300	155.5	114.3	73.0	32.5	1.60	4 x 3/4"	117.5	142.5
2"	150	152.4	120.6	92.0	19.0	1.60	4 x 5/8"	104.0	129.0
	300	165.1	127.0	92.0	22.0	1.60	4 x 5/8"	107.0	132.0